



Real People. Real Solutions.

Mission Township

Huxtable Point Road & East Horseshoe Lake Road



Mission Township, MN

'A QUIET PLACE TO BE'

Presented by:

Bolton & Menk, Inc.

April 17, 2024 @ 6:00 P.M.

Project Areas



MISSION TOWNSHIP CONSTRUCTION PLANS FOR HUXTABLE POINT RD & E HORSESHOE LAKE RD

FULL DEPTH RECLAMATION AND BITUMINOUS PAVING
NOVEMBER, 2023

NOTE: EXISTING UTILITY INFORMATION SHOWN ON THIS PLAN HAS BEEN PROVIDED BY THE UTILITY OWNER. THE CONTRACTOR SHALL FIELD VERIFY EXACT LOCATIONS PRIOR TO COMMENCING CONSTRUCTION AS REQUIRED BY STATE LAW. NOTIFY Gopher State One Call, 1-800-252-1366 OR 651-454-0002.

THE SUBSURFACE UTILITY INFORMATION IN THIS PLAN IS UTILITY QUALITY LEVEL D UNLESS OTHERWISE NOTED. THIS UTILITY LEVEL WAS DETERMINED ACCORDING TO THE GUIDELINES OF CVA/SCE 38-02, ENTITLED "STANDARD GUIDELINES FOR THE COLLECTION AND DEPICTION OF EXISTING SUBSURFACE UTILITY DATA."



SHEET NUMBER	SHEET TITLE
GENERAL	
G0.01	TITLE SHEET
G1.01	STATEMENT OF ESTIMATED QUANTITIES
CIVIL	
C1.01 - C1.03	TABLES, DETAILS, TYPICAL SECTIONS
C6.01 - C6.07	STREET PLAN SHEETS
C7.01	TRAFFIC CONTROL
THIS PLAN SET CONTAINS 13 SHEETS.	

© Bolton & Menk, Inc. 2023. All Rights Reserved. Project No. 23-001. Mission Township, MN. 11/15/2023. 11/15/2023.

MAP LEGEND
PROJECT LIMITS

DESIGNED BY: BRYAN D. DORR
BRYAN D. DORR
4134
01/15/2024



7036 DESIGN ROAD, SUITE 200
BARTER, MINNESOTA 56425
Phone: (763) 825-9686
Email: brian@bolton-menk.com
www.bolton-menk.com

DATE	BY	REVISION
11/15/2023	BD	ISSUE FOR PERMIT

MISSION TOWNSHIP, CROW WING COUNTY, MINNESOTA
2024 ROAD IMPROVEMENTS
TITLE

SHEET
G0.01



Proposed Improvement

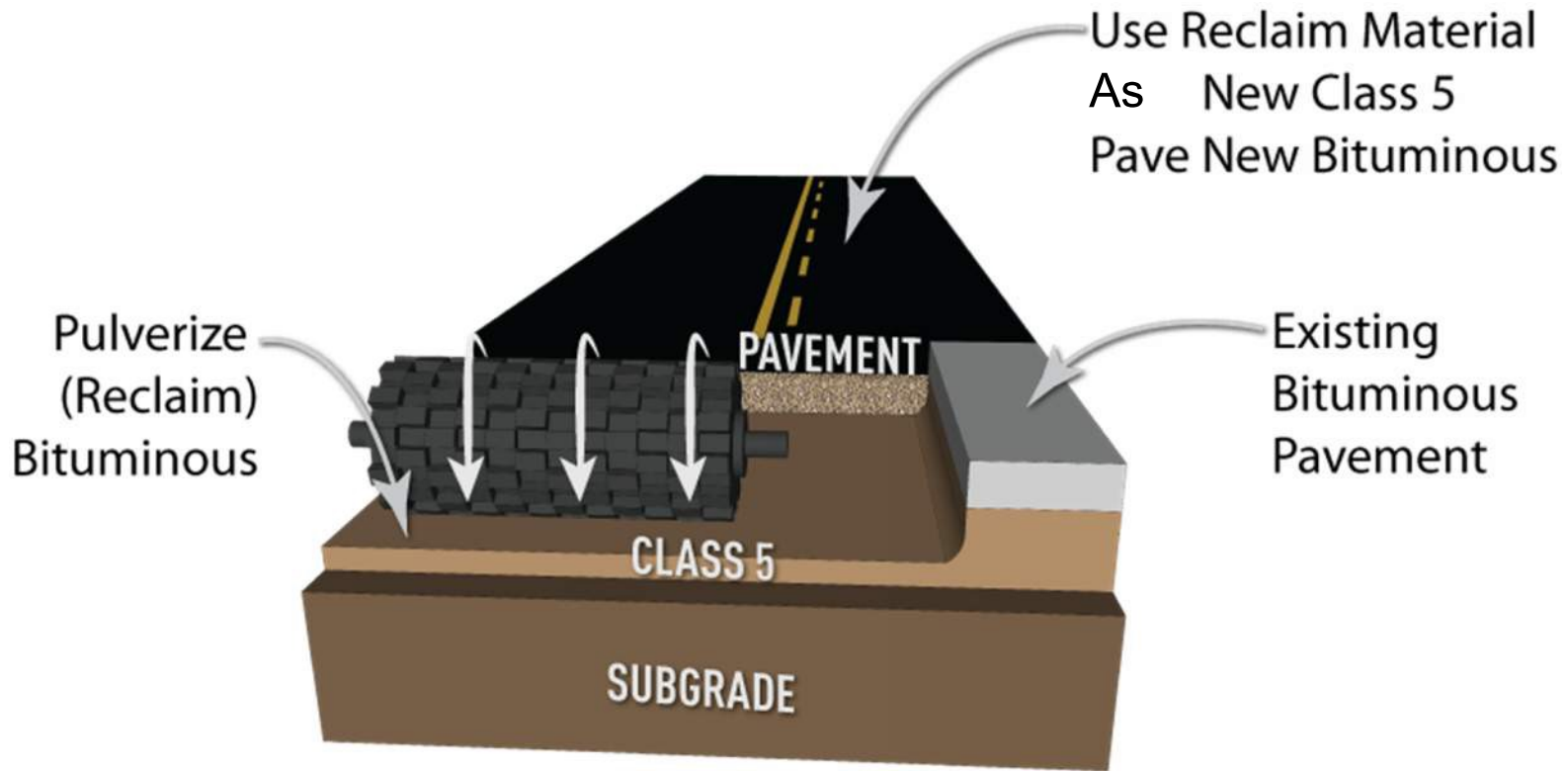

Full Depth Reclamation



Proposed Improvement



Proposed Improvement



Proposed Improvement

- Driveway Connections
 - Driveways will be connected 5' off the edge of the roadway with material matching the existing driveway
 - Gravel, Bituminous, Concrete
 - Concrete – No access while concrete curing

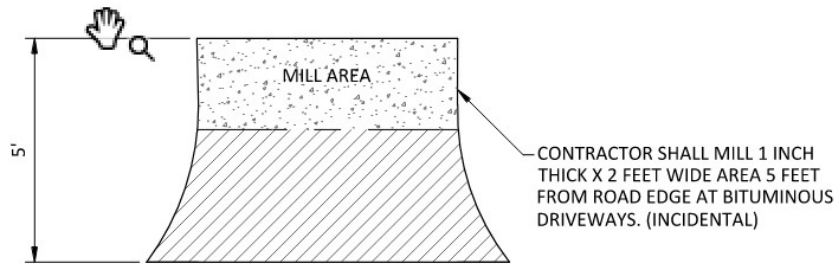

NOTE: CONTRACTOR SHALL PLACE TACK OIL AT RATE OF 0.08 GALLONS PER SQUARE YARD PRIOR TO OVERLAYING DRIVEWAY CONNECTIONS TO MATCH RAISED ROAD ELEVATION. QUANTITY FOR DRIVEWAY PAVING IS INCLUDED IN BITUMINOUS WEAR COURSE PAY ITEM.

04
C1.01 BITUMINOUS DRIVEWAY TYPICAL DETAIL

NOT TO SCALE

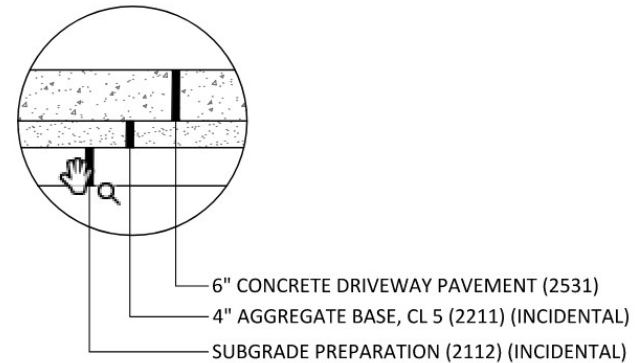

03
C1.01 CONCRETE DRIVEWAY PAVEMENT

NOT TO SCALE





Proposed Improvement

- Driveway Connections
 - Driveways will be connected 5' off the edge of the roadway with material matching the existing driveway
 - Gravel, Bituminous, Concrete
 - Concrete – No access while concrete curing





Proposed Improvement

- Mailbox Supports
 - Per Township Policy swing away mailbox supports will be installed where not currently present.
 - Existing swing away supports will be adjusted vertically.

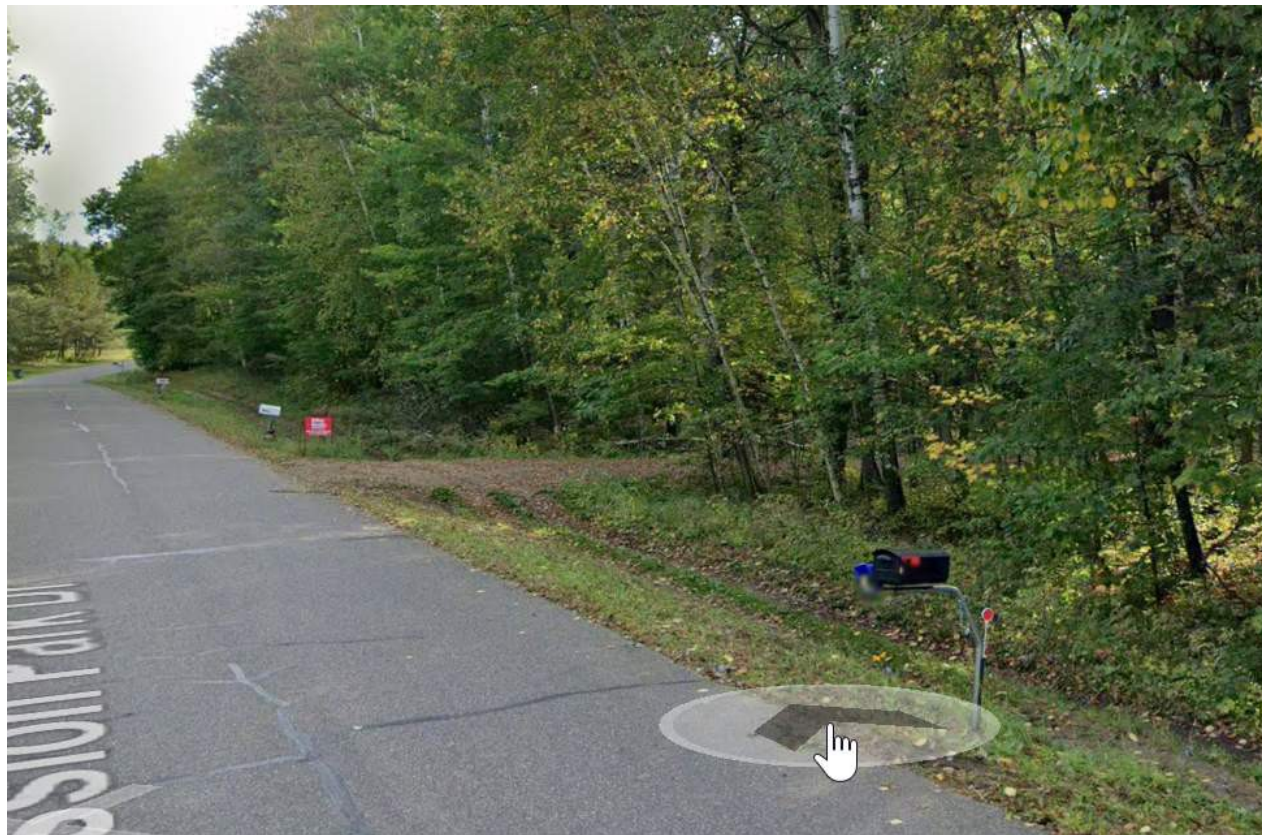



Proposed Improvement

- On Huxtable Point Road where manicured lawns abut the pavement, topsoil borrow shall be blended in over a four-foot-wide area and seeded.
 - Property Owner will be responsible to adjust irrigation heads.



Project Schedule

Subject to Change due to Weather

2024 APRIL

SUNDAY	MONDAY	TUESDAY	WEDNESDAY	THURSDAY	FRIDAY	SATURDAY
	1	2	3	4	5	6
7	8	9	10	11	12	13
14	15	16	17	18	19	20
21	22	23	24	25		
	Reclaiming		Information Meeting			
28	29	30				
	Bituminous Paving		Grading			



Reclaiming

Grading

Bituminous Paving



Project Schedule

Subject to Change due to Weather

MAY 2024

SUNDAY	MONDAY	TUESDAY	WEDNESDAY	THURSDAY	FRIDAY	SATURDAY
			1	2	3	4
	Bituminous Paving			Shouldering		
5	6		7	8	Concrete Driveways	9
	Seeding					
12	13	Mailbox Supports		15		16 Fishing Opener
			14			
Mother's Day						
19	20		21	22		23
26	27		28	29		30
	Memorial Day					



Project Contacts



- Mission Township
 - Town Board Chair – Jon Auge
 - Phone: 651-335-6555
- Contractor
 - Anderson Brothers Construction
 - Project Manager – Mike Niemi
 - Phone: 218-820-9944
- Township Engineer
 - Bolton & Menk
 - Project Engineer – Bryan Drown
 - Phone: 218-821-5242





Real People. Real Solutions.

COMMENTS OR QUESTIONS?



Mission Township, MN

'A QUIET PLACE TO BE'